

River Courses

- S 72 1/2 W 40
- S 62 W 39
- S 56 W 29
- S 62 W 40
- S 27 1/4 W 17

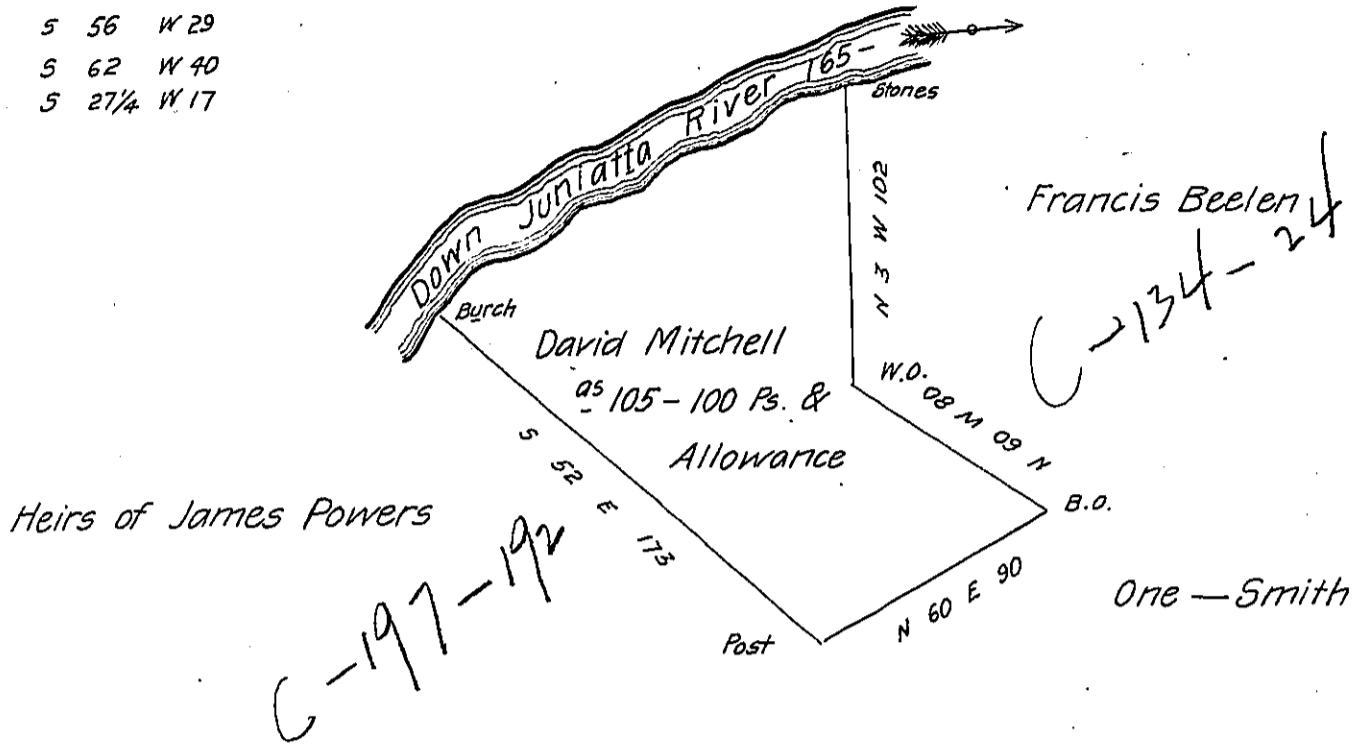

The Draft of a Tract of Land Situate in Juniatta Township, Cum-  
berland County Containing one hundred & five acres one hundred perches  
and the allowance Surveyed May 6<sup>th</sup> 1814. In pursuance of a Warrant grant-  
ed to David Mitchell date January 19<sup>th</sup> 1790

Robt Clark D.S.

To Rich<sup>d</sup> T. Leech Esquire  
Surveyor General of Penn<sup>a</sup>

IN TESTIMONY that the above is a copy of the original remaining on file in  
the Department of Internal Affairs of Pennsylvania, made  
conformably to an Act of Assembly approved the 16th day of  
February, 1833, I have hereunto set my Hand and caused  
the Seal of said Department to be affixed at Harrisburg,  
this eighteenth day of April 1906

*Isaac D. Brown*  
Secretary of Internal Affairs.